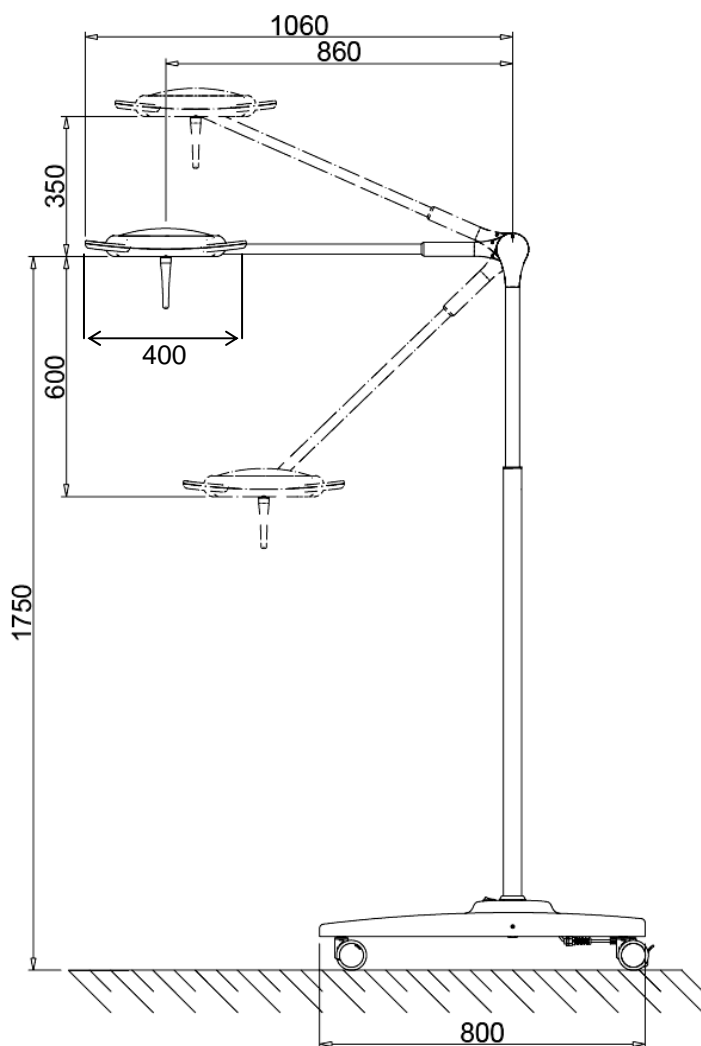

Slim
TECHNICAL DATA

Performances at 1mt distance

	Slim
Light intensity at 1m (Ec)	50klx
Color temperature (K)	5000
Color rendering index (CRI)	94
Luminous source	n°12Led x2W
Focusing	Fissa
Depth of light field	150 cm
Diameter of light field d ₁₀	14 cm
Radiated energy (Ee)	119 W/m ²

Electrical data

Primary voltage (Vac)	100÷240 V
Secondary voltage (Vdc)	24 V
Frequency	50/60 Hz
Power absorption	40 VA

 TECNO-GAZ	SLIM lamp MOBILE version	GB	13/12/12
		Rev.0	Page 2 of 3

- ELECTRICAL ARRANGEMENT OF THE SITE

The electrical system arrangement works of the site used as medical premises to power the Product must be carried out in a safe way according to the standards by qualified personnel.

By qualified personnel we mean, including but not limited to, the following professionals:

Electro-technician licensed to practise as electrician.

The electrical plant of the site in which will be carried out the installation, must complies with IEC 60364-7-710 (standards for electrical installations for rooms used for medical purposes), and the laws and / or regulations in force.

The electrical system must be certified by an electrician licensed to issue the conformity certificate.

The verification of the grounding circuit must be certified as required by the norms in force.

The electrical system shall provide the use of appropriate cables in reference to the electrical characteristics of the product to be supplied.

The electrical system must be provided with a fuse protection or magneto-thermal switch upstream the product, to avoid the risk of damage as a result of a failure and / or malfunction of the electricity network.

ELECTRICAL PLANT CONFORMITY

DECLARATION

Based on the above points, it is hereby certified that the electrical arrangement of the site, carried out at:

Customer name and address: _____

were carried out in solid and safe way, according to the rule of art.

Engineer calculator name and address: _____

Signature _____ **Date** _____

Executing works firm name and address: _____

Signature _____ **Date** _____

IMPORTANT:

TECNO-GAZ S.p.A. declines all responsibility for any electrical failure can occur over time

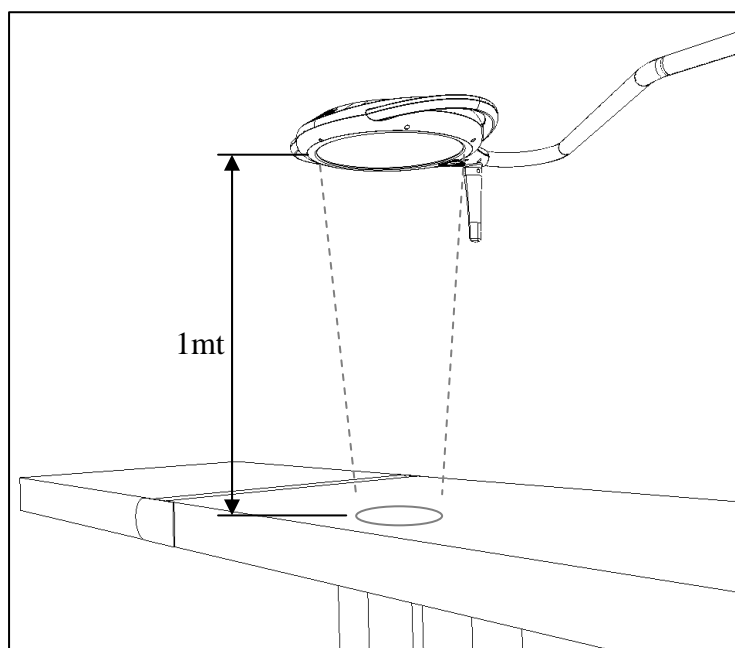
WORKING DISTANCE

To obtain the optimization of the light intensity, it is recommended to use the product at the distance of 1m.

However, the product ensures a good light intensity even when used at a distance range between 80cm and 140cm